

LEGEND

1. WETLAND LOCATIONS SHOWN HERE ARE BASED ON A PLAN ENTITLED "PROPERTY OF SIPPICAN HARBOR REALTY TRUST IN MARION, MA., WETLANDS PLAN OF LAND", DATED MAY 11, 1990 AND REVISED JULY 25, 1990. UNDER A DETERMINATION OF APPLICABILITY ISSUED BY THE MARION CONSERVATION COMMISSION ON SEPT. 6, 1990.
2. BENCH MARK FOR TOPOGRAPHIC DATA WAS BASED ON MASSACHUSETTS STATE BENCH MARK # 4135 LOCATED NORTH OF STONE GATE POST ON THE NORTH SIDE OF ENTRANCE TO ESTATE OF G.W. MITTON ON POINT ROAD; A CHISELED SQUARE IN LEDGE OUTCROP AT ELEVATION 44.64' MLW.
3. FLOOD ZONE LINES SHOWN APPROXIMATELY FROM "FIRM MAP # 255213 0002D ", AND REVISED FEB. 17, 1988.
4. MARION ZONING DISTRICTS SHOWN APPROXIMATELY FROM MAP ENTITLED "ZONING MAP, TOWN OF MARION, DATED FEBRUARY 25, 1974."

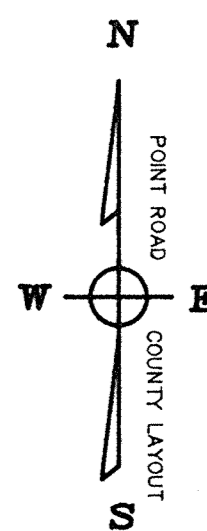
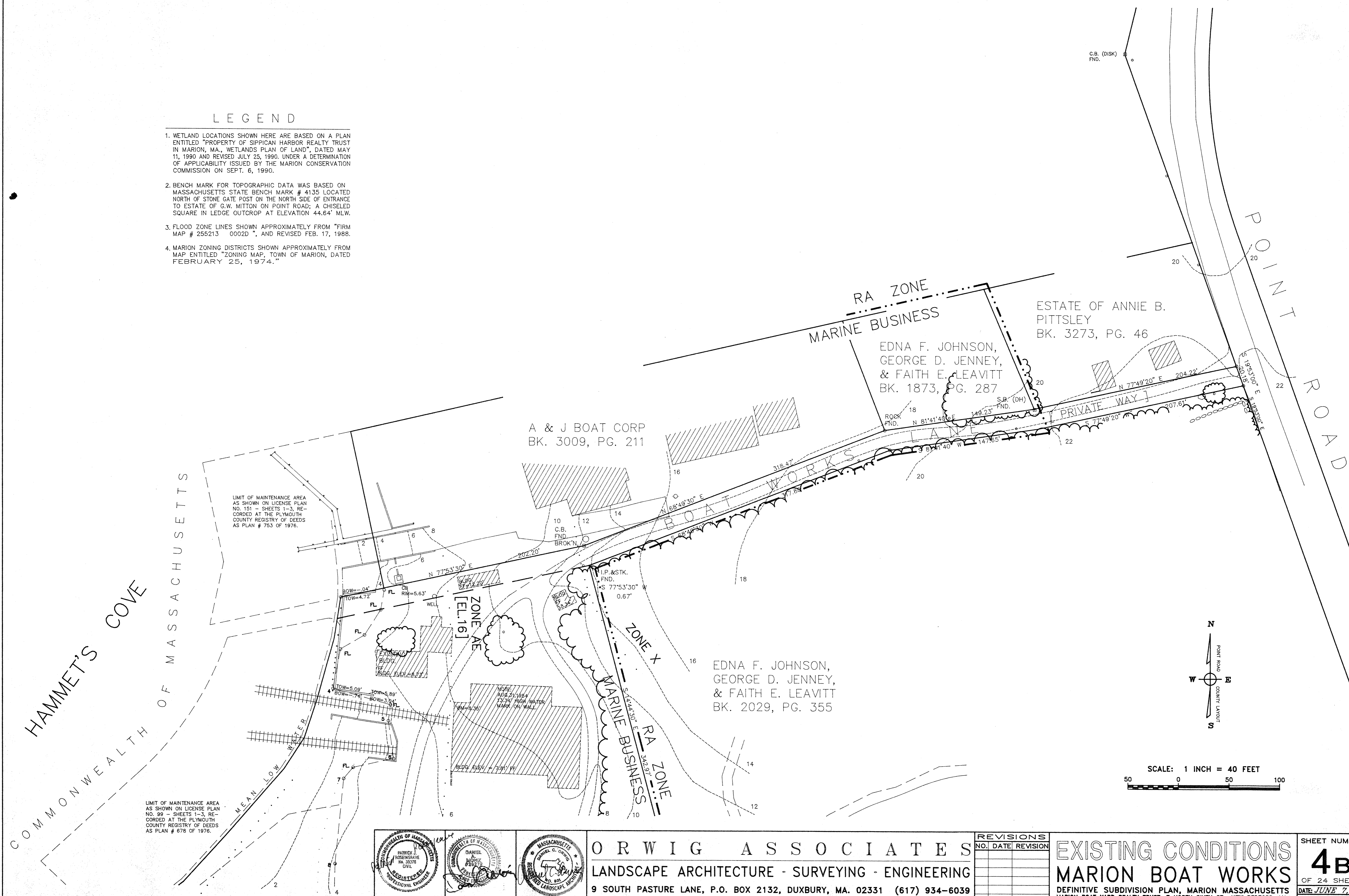

SCALE: 1 INCH = 40 FEET

50 0 50 100

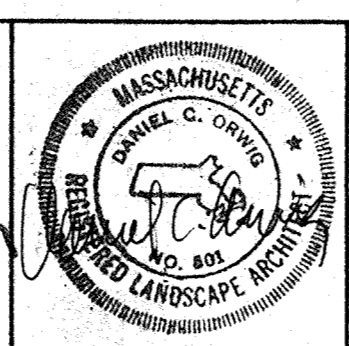
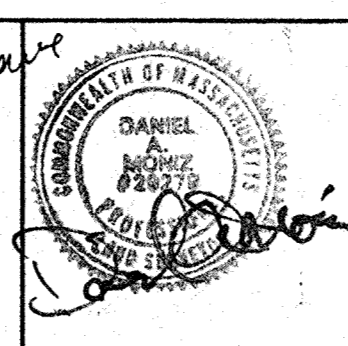
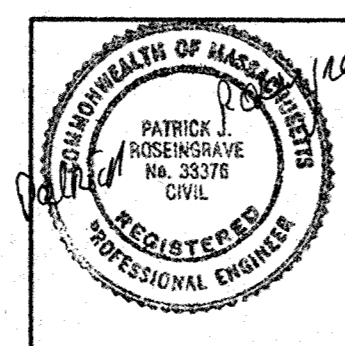

ORWIG ASSOCIATES
 LANDSCAPE ARCHITECTURE - SURVEYING - ENGINEERING
 9 SOUTH PASTURE LANE, P.O. BOX 2132, DUXBURY, MA. 02331 (617) 934-6039

NO.	DATE	REVISION

EXISTING CONDITIONS
MARION BOAT WORKS
 DEFINITIVE SUBDIVISION PLAN, MARION MASSACHUSETTS
 MARION BOAT YARD REALTY TRUST, 7 NORTH SIXTH ST., NEW BEDFORD, MA.

SHEET NUMBER
4B
 OF 24 SHEETS
 DATE: JUNE 7, '91
 FILE: D:\HAM\4B