

It is a violation of law for any person unless he is acting under the direction of a licensed professional engineer to alter this document.

This drawing was prepared at the scale indicated in the title block. Inaccuracies in the stated scale may be introduced when drawings are reproduced by any means. Use the graphic scale bar to determine the actual scale of this drawing.

GENERAL NOTES

1. SOIL EVALUATION AND ENGINEERING TESTS PERFORMED BY ROY OKURAWSKI, REGISTERED PROFESSIONAL ENGINEER AND SOIL EVALUATOR IN MASSACHUSETTS.
2. EXISTING TOPOGRAPHIC INFORMATION SHOWN SURVEYED BY CLE ENGINEERING, INC.
3. ALL CONSTRUCTION IS TO CONFORM TO THE TOWN OF MARION SEWER AND WATER DEPARTMENT STANDARDS UNLESS OTHERWISE SPECIFIED BY THE ENGINEER.
4. ELEVATIONS ARE BASED ON APPROXIMATE MEAN LOW WATER DATUM AND SHOULD ONLY BE USED AS A CONSTRUCTION DATUM. ALL PIPE IS TO BE LAID AT A MINIMUM OF 4.5' BELOW FINISHED GRADE, AND A MAXIMUM OF 8' TO FINISHED GRADE.
5. NO EXCAVATION IS TO BE DONE UNTIL BOTH DIG-SAFE AND PRIVATE UTILITY CONSULTANTS HAVE MARKED ALL UNDERGROUND UTILITIES INCLUDING GAS, ELECTRIC, WATER, AND SEWER.
6. ALL WATER SYSTEMS ARE TO BE INSPECTED BEFORE BACKFILLING, AND PRESSURE TESTED TO THE REQUIREMENTS OF THE LOCAL INSPECTOR.
7. NO TREES WITH A LARGER DIAMETER THAN 3" SHALL BE CUT DOWN WITHOUT THE APPROVAL OF THE GREAT HILL TRUST.

REV.	DATE	DESCRIPTION

TITLE

PLAN AND PROFILE

PROJECT

GREAT HILL ESTATE
MARION, MA

PREPARED FOR

GREAT HILL TRUST
DELANO ROAD
MARION, MA 02788

DATE: 08-14-01

DESIGNED BY: REO

CHECKED BY: CGP

DRAWN BY: REO/KFR

SCALE: AS NOTED

JOB NO.: 00079-100

DWG NO.: 001

FILE NO.: 001

3

SHEET 3 OF 11

GRAPHIC SCALE

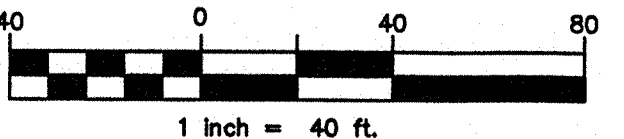

LEGEND		
EXISTING		PROPOSED/REPLACED
— 30 —	1" CONTOUR	
— 30 —	5' CONTOUR	
— 30 —	DRAIN LINE	
— 30 —	WATER LINE	
— 30 —	SEWER LINE	
— 30 —	OVERHEAD ELECTRIC	
— 30 —	FIRE HYDRANT	
— 30 —	CATCH BASIN	
— 30 —	GATE VALVE	
— 30 —	WATER SHUT OFF	
— 30 —	UTILITY POLE	
— 30 —	EDGE OF PAVEMENT/CURB	
90	90° BEND	
45	45° BEND	
22	22 1/2° BEND	
11	11 1/4° BEND	

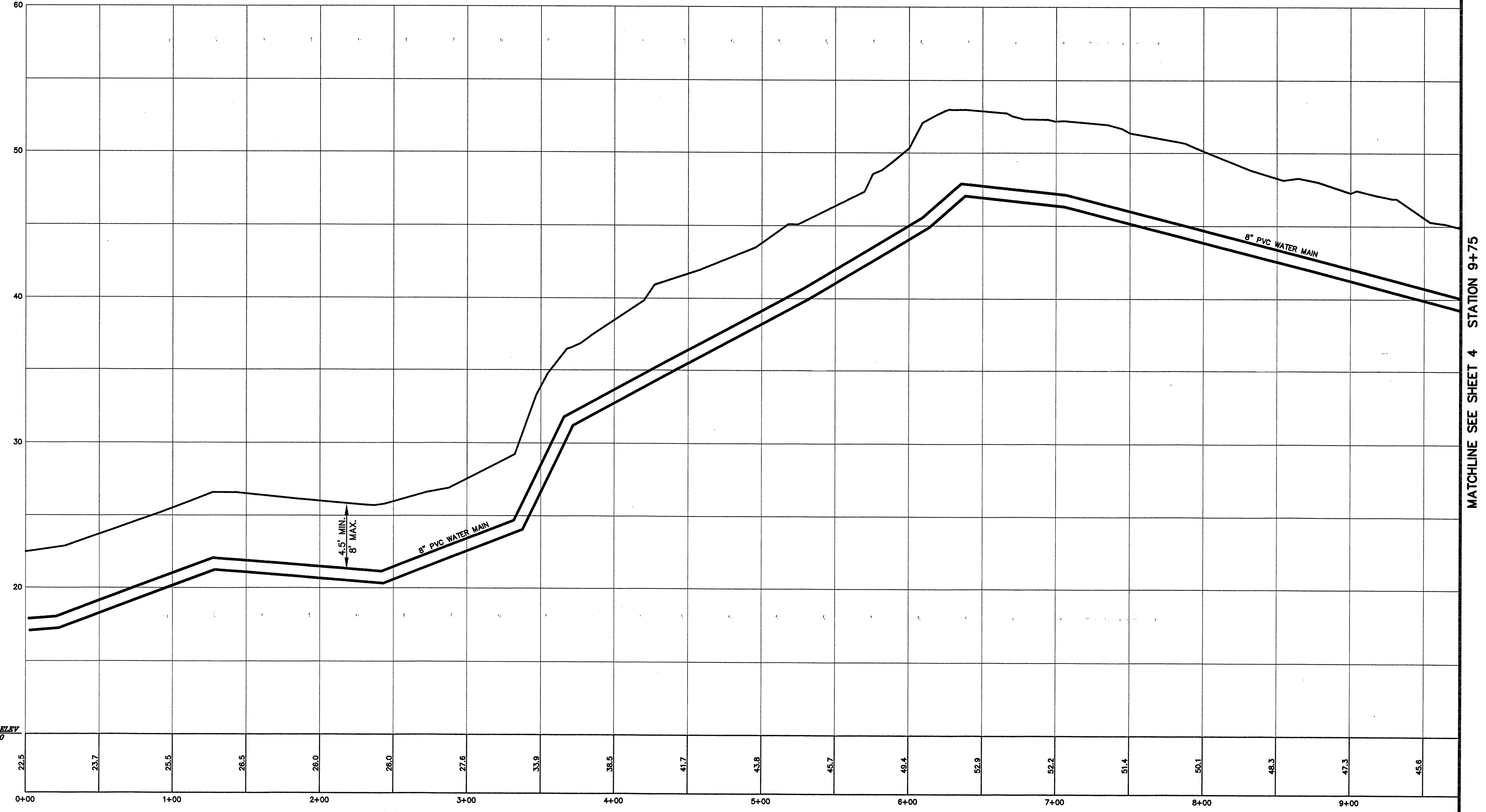
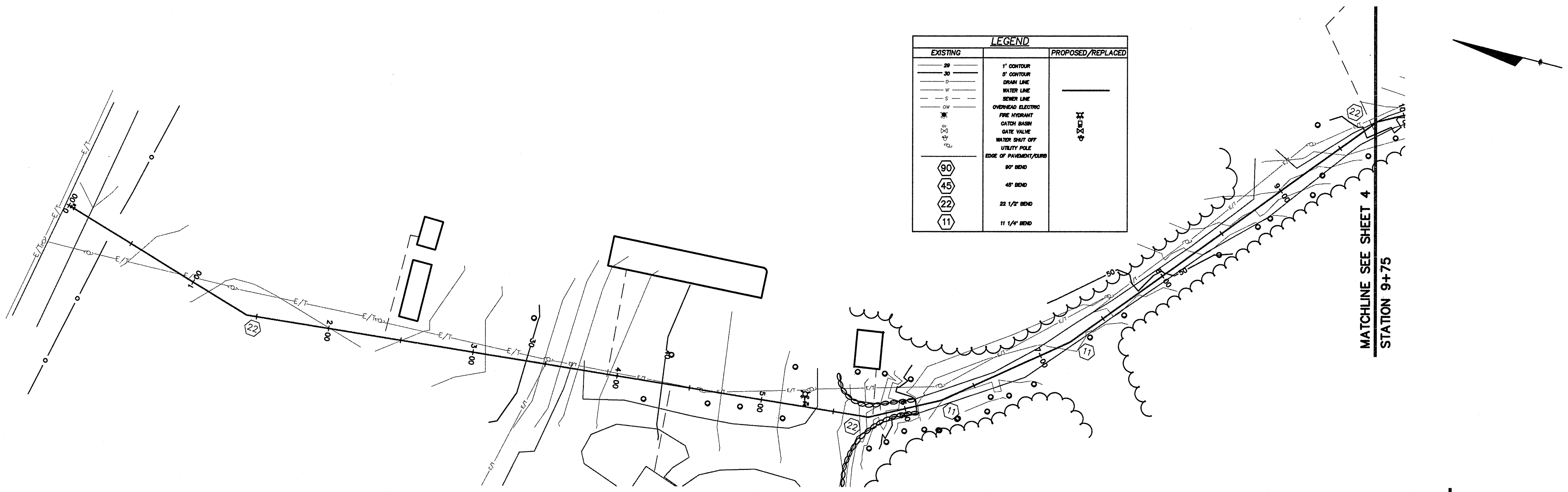

DATUM ELEV.
10.00